



DRAWER UNIT / SHELF UNIT ASSEMBLY INSTRUCTIONS

Fold on all score lines first.

1x



If included

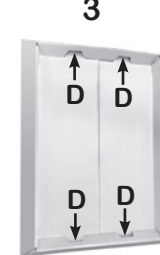
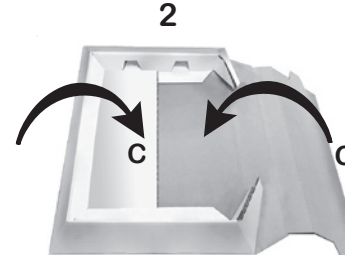
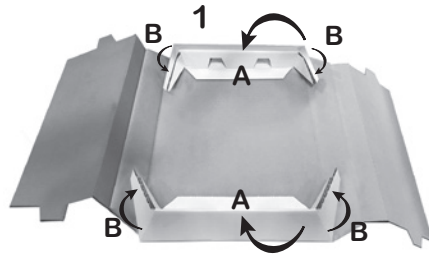

1x

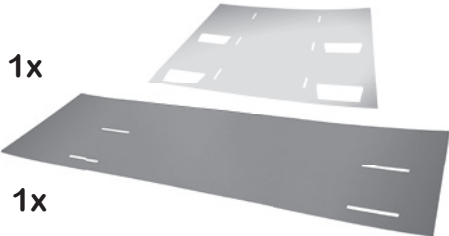

3 and 4 shelf units will be taller

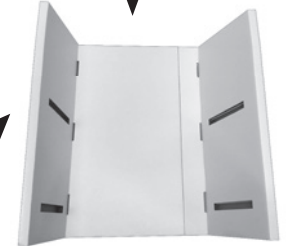
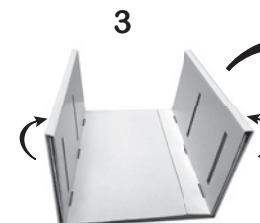
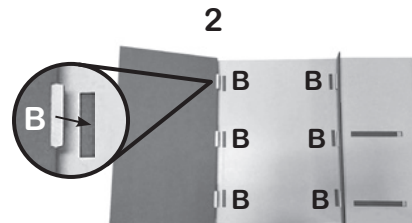
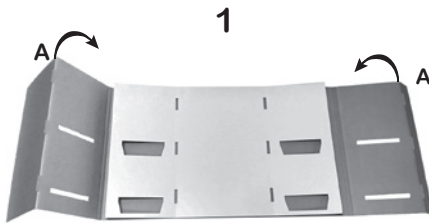

2x or
 3x or
 4x

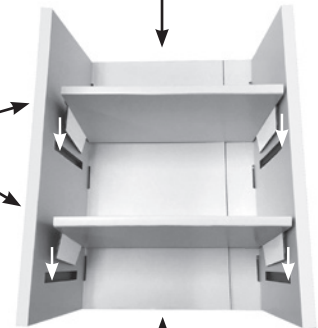
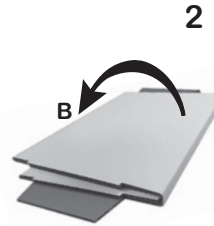
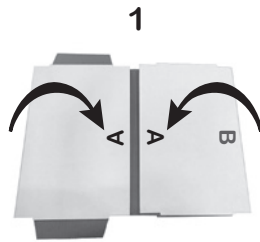

2x or
 3x or
 4x

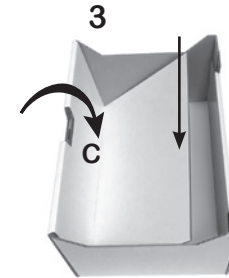
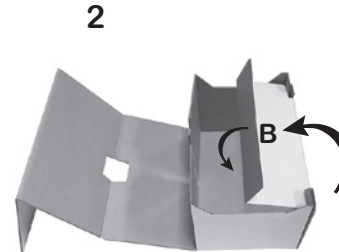
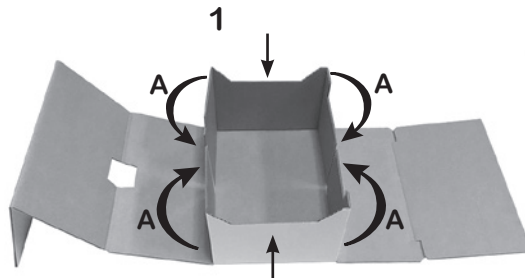

Patent Pending

Due to the characteristics corrugated cardboard, these products are not meant to withstand an excessive amount of weight. Standing or stacking on Korrugate It products is not recommended. Korrugate It is not responsible for any misuse of product.

Occasionally, slight tearing appears on the inside of the pieces. This occurs during the manufacturing process and does not impact the appearance or structural integrity of the assembled furniture in any way.